

## Installation Manual

5589000J

# GR30-Series Guide Rail Systems

## Models

### GR30-Series 3" Pump Disconnect for Ordinary Locations

- For use with LE70, LE100, LEH100, LEH150, and LEH200-Series Pumps

### GR30NS-Series 3" Non-Sparking Pump Disconnect for Hazardous Locations

- For use with XLE50, XLE70, XLE100, and XLE150-Series Pumps

## Features

- Heavy-duty cast iron construction
- Accommodates single 1-1/4" guide pipe and 3" discharge pipe
- Auto-alignment feature
- Upper rail support bracket
- Includes sealing grommet

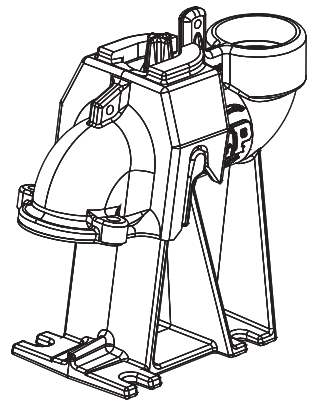
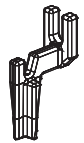

### NOTICE

Installer: Manual must remain with owner/operator.

Record information:

7000 Apple Tree Avenue  
Bergen, NY 14416  
ph: 1-800-543-2550  
fax: 1-585-494-1839  
www.LibertyPumps.com

Keep this manual handy for future reference.

For replacement manual, visit LibertyPumps.com,  
or contact Liberty Pumps at 1-800-543-2550.

Retain dated sales receipt for warranty.

Model: \_\_\_\_\_

Serial: \_\_\_\_\_

Mfg Date: \_\_\_\_\_

Install Date: \_\_\_\_\_

## GR30 Assembly

The GR30 quick pump disconnect assembly provides easy installation and removal of the pump. When installed correctly, the guide rail assembly creates a tight discharge seal and provides a means to lift the pump without disconnecting any of the discharge piping. Ensure that installation is done per instructions.

The guide rail system consists of three parts: Upper Rail Support Bracket, Mounting Claw, and Base.

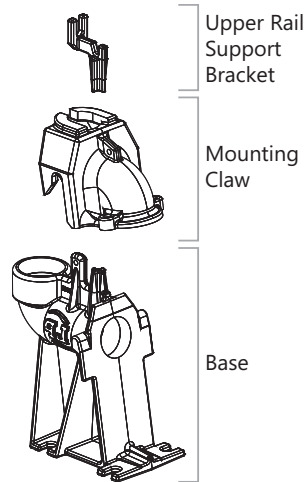

3. Insert upper rail support bracket into guide rail pipe. Place the upper rail support bracket at top of vault, mounting to secure vault structure. Once installed, tighten upper rail support top nuts.

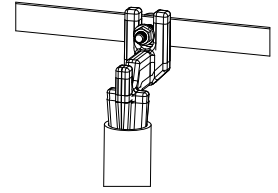

*Pipe is not included; a heavy guide rail pipe of 1-1/4" galvanized or stainless steel is recommended.*

4. Attach lifting chain to pump as follows:
  - A. Pump side - 6 links
  - B. Claw side - 13 links
 This maintains the pump angle of 10–25° to ensure a complete seal to guide rail base.

### Preparation

The claw has a sealing grommet that provides the seal between the claw and base, and also the seal between the claw and the pump.

1. Insert grommet into mounting claw.
2. Tighten until the washer does not spin freely. Do not over-tighten.
3. Apply a light amount of sealing grease (provided) to the face of the grommet that sits on the guide rail base.

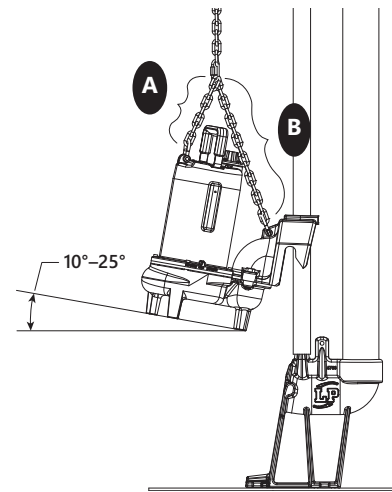
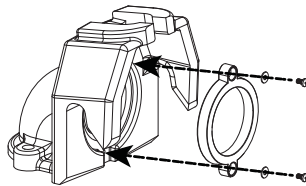

### Installation

1. Mount the base to the floor of the tank, referring to the **Base Mounting Template** measurements. Secure the base to the basin floor at the base slots with 1/2" bolts (stainless steel recommended). When mounting to a concrete surface, use 1/2" or 5/8" (14 or 16 mm) thread wedge anchors.
2. Using supplied bolts, mount the claw onto the pump discharge.

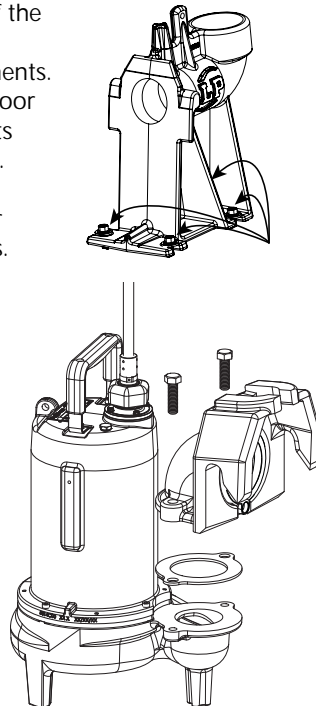

### Operation

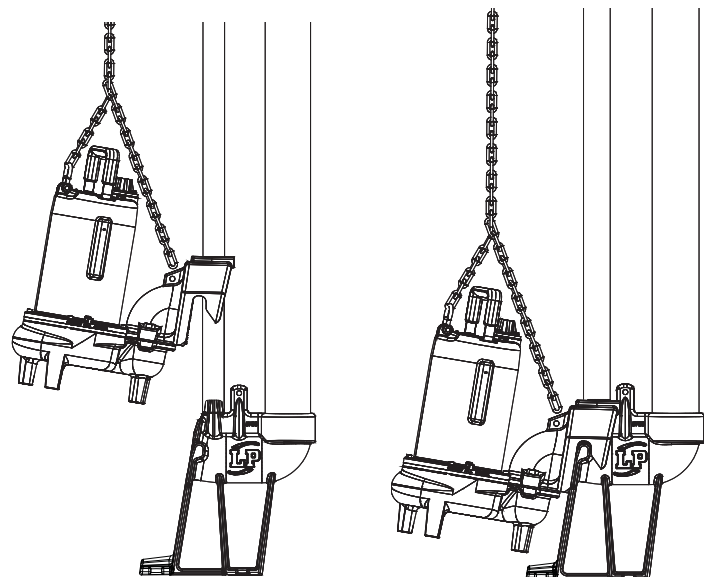

Disconnected view

Connected view

This page intentionally left blank.

Esta página se dejó en blanco intencionalmente.

Cette page a été laissée vide intentionnellement.

***Base Mounting Template***

***Plantilla de montaje de la base***

***Gabarit de montage de base***

---

---

